

微型電磁閥

MS10-2A



L 型

M 型

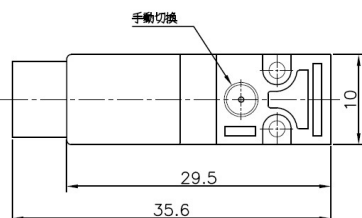
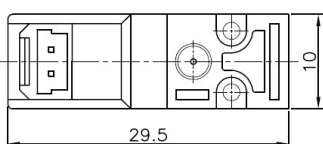
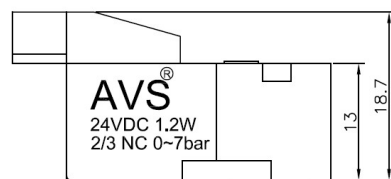
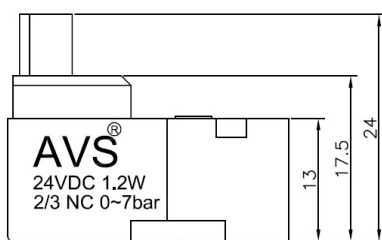
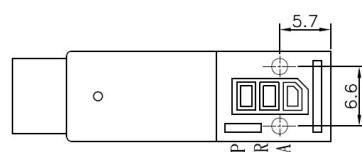
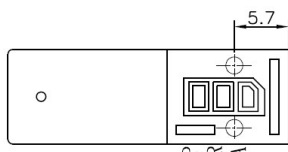
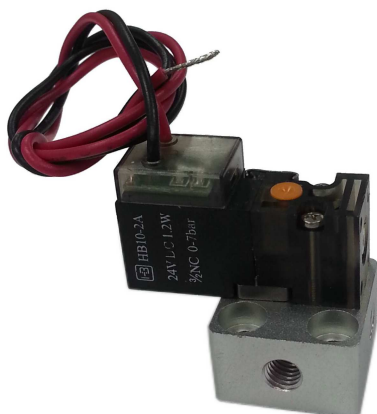

規格 Specifications

位通數	3 口 2 位常開/常閉
使用流體	空氣、惰性氣體
環境及流體溫度	-10~75°C
工作壓力	0~7 bar
通徑	φ0.7mm、φ1.0mm、φ1.2mm
導線引出方式	垂直腳件式(L 行)、水平插角式(M 型)
標準電壓	DC24V/12V
電壓範圍	±10%
功率	1W/1.2W/雙功率
絕緣等級	H
使用壽命	>5000 萬次
工作頻率	>30Hz
反應時間	6~8ms
防護等級	防塵

微型電磁閥

MS10-2A



單座尺寸

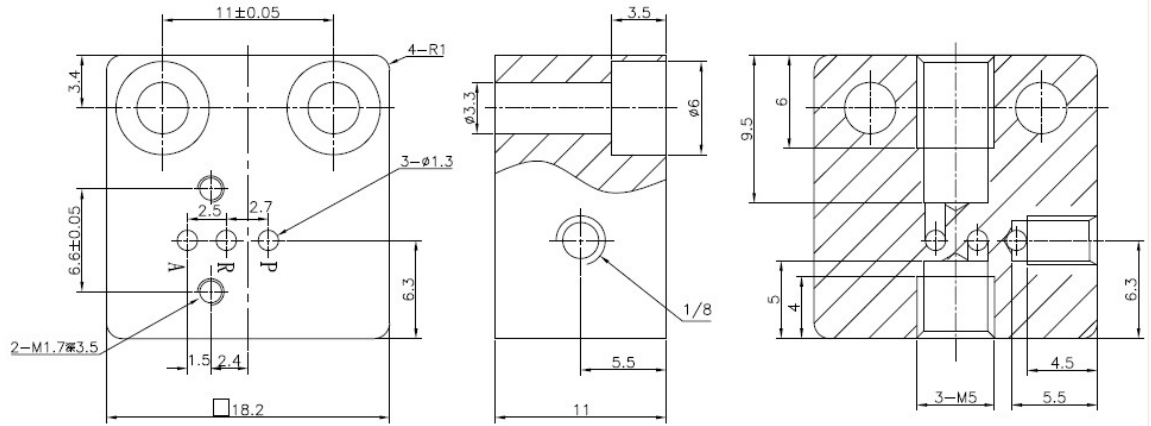

聯座

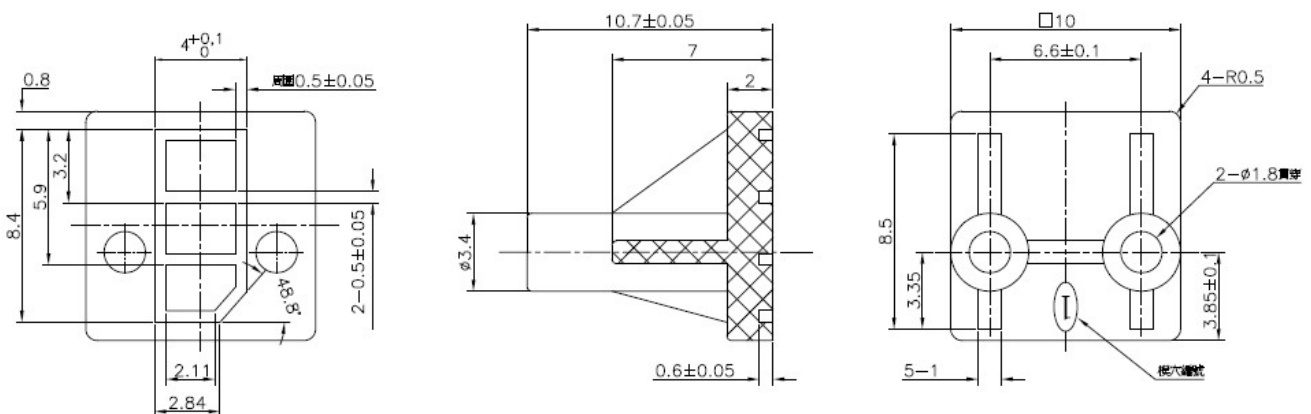
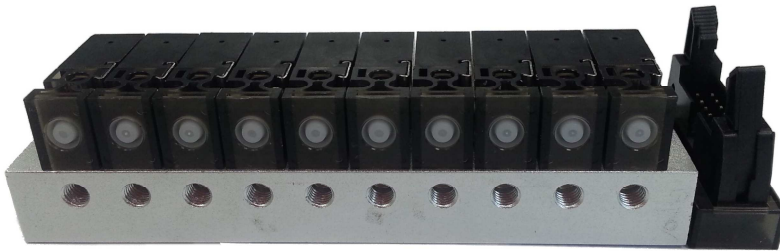

△蓋板尺寸

微型電磁閥

MS10-2A

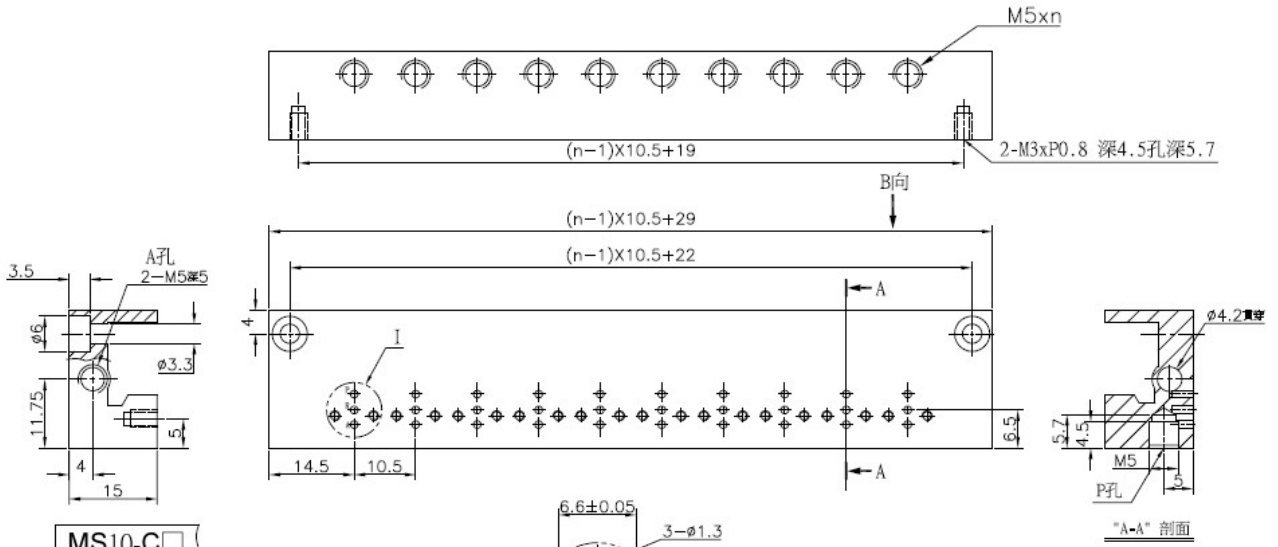

MS10-C □

B向180°旋轉圖

側向氣匯流板訂購代碼: MS10-C □
註: n為聯數

↑
聯數

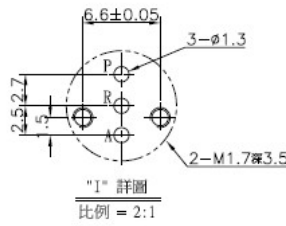

"I" 詳圖
比例 = 2:1

△側向出氣聯座 MS10-C 聯數

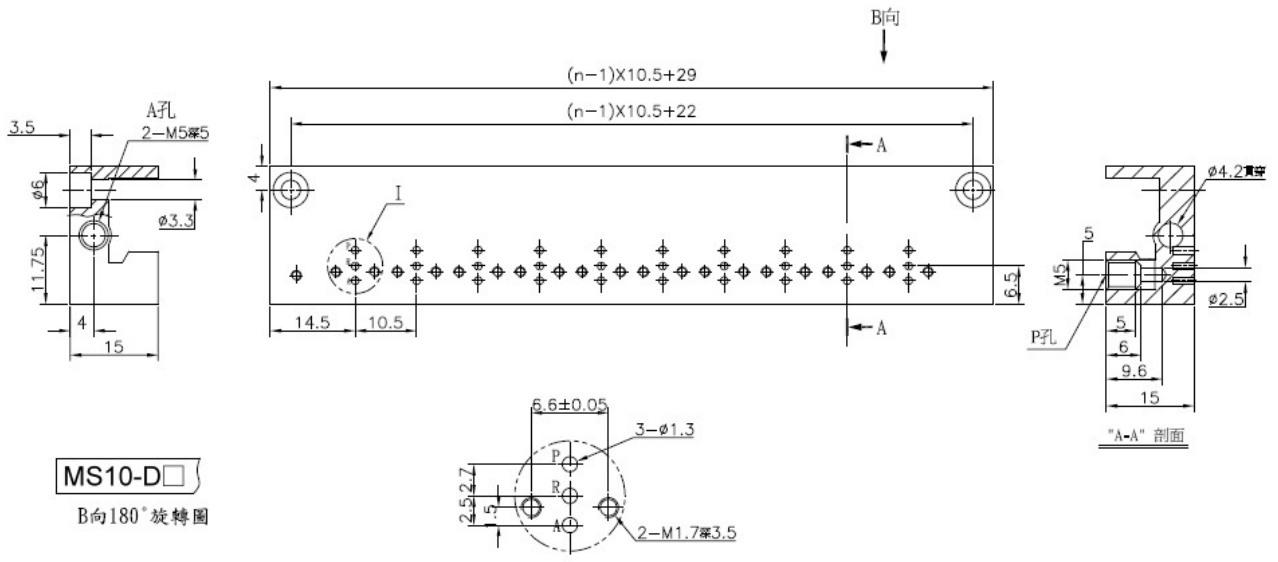

MS10-D □

B向180°旋轉圖

底部氣匯流板訂購代碼: MS10-D □
註: n為聯數

↑
聯數

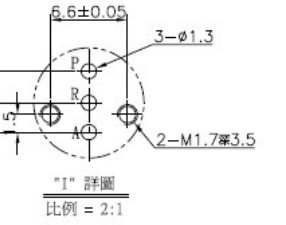

"I" 詳圖
比例 = 2:1

△底部出氣聯座 MS10-D 聯數