

# 3口2位引導式電磁閥 Pilot Solenoid

## SMG 3 Series (25bar)



### 產品規格 SPECIFICATION

型號 Model	SMG3-8-3/8	SMG3-15-1/2
公稱通徑 Orifice	8mm	15mm
接管口徑 Port Size	G3/8"	G1/2"
使用壓力 Operating pressure	3~25 bar	
工作溫度 Operating temperature	0~50°C	
壽命次數 life	150 萬次以上 1.5 million times	
外部引導壓力 Pilot pressure	3bar	

### 外觀尺寸 OVERALL DIMENSION

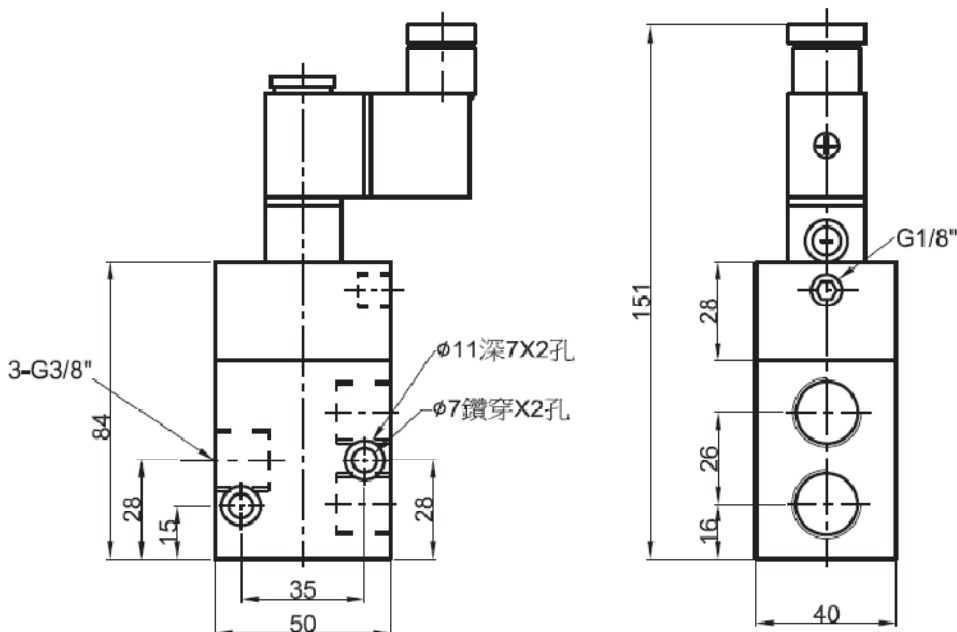

△ SMG3-8-3/8



**Kao Lu Enterprises Co., Ltd. TEL:886-4-24874219 · 24860626**  
**Genn Dih Enterprises Co., Ltd. FAX:886-4-24864269 · 24862824**  
**Web:www.genndih.com E-mail:genndih@ms43.hinet.net**  
**No. 17, Lane 822, Sec. 2, Zhongxing Rd., Dail Dist., Taichung City 41244, Taiwan(R.O.C)**

# 3口2位引導式電磁閥 Pilot Solenoid

## SMG 3 Series (25bar)



### 外觀尺寸 OVERALL DIMENSION

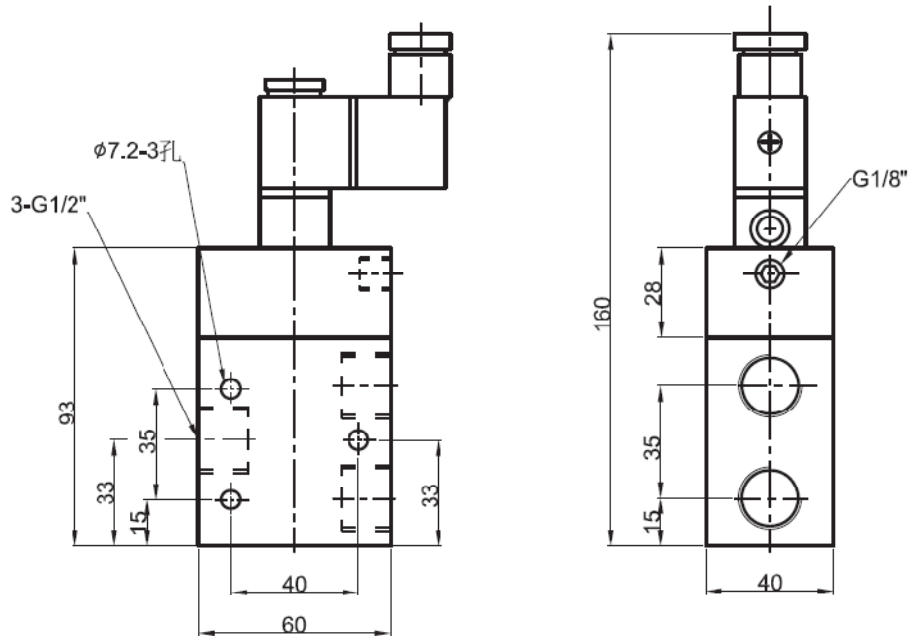

△ SMG3-15-1/2

